

BESTMA[®]



alki
TECHNIK
GmbH

Torque Wrench TU
Convertible Type Torque Wrench TX

BESTMA[®] Convertible Type Torque Wrench TX

The application-oriented
BESTMA construction program:



The **BESTMA-drive element** and the **hexagon link** are easily interchangeable. The **uni-swivel hose connector** assures a safe and comfortable handling.

The **BESTMA Convertible Type Torque Wrench** is used, whenever there is a high demand for flexibility and power.

**The BESTMA triple advantage:
Compact, light weight and large torque.**

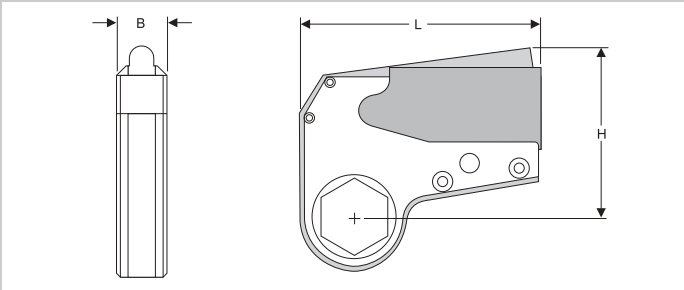
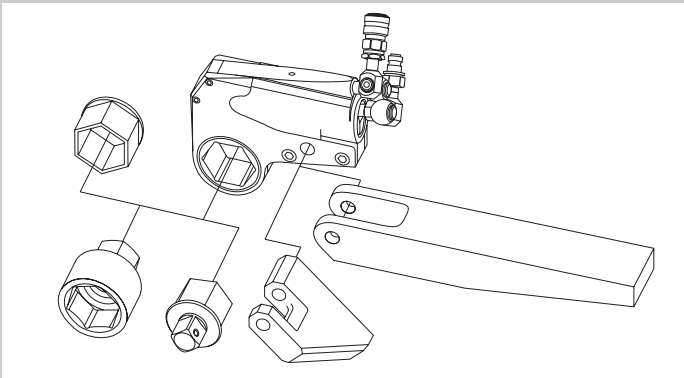

Technical Information

- Safe tightening and loosening up to 48.000 Nm **despite compact size**
- Well thought-out construction and latest material technology guarantee extraordinary durability
- A 2-hydraulic hose-system assures long-term consistent torque accuracy
- Quick interchangeability of hexagon links and torcUP-drive element
- Uni-swivel hose connector
- Versatile accessories allow operation within large clearance - high tuning offers a wide range of application
- Our accessory catalogue offers you a large scale of hexagon link adapters (STA) as well as direct insertable hexagon link attachments (STABI) and all power nuts (STACO) with optimized power input (special sizes upon request)

Techn. Details BESTMA Convertible Type Torque Wrench TX

Type/ Ref.No.		TX 2	TX 4	TX 8	TX 16	TX 32
Hexagon Link SW	from	27mm	36mm	55mm	80mm	80mm
	to	55mm	70mm	95mm	115mm	145mm
Min. Torque	(Nm)	260	530	1120	2110	4350
Max. Torque	(Nm)	2600	5330	11650	22410	48125
Drive Element Weight *(kg)		1,5	2,7	5,3	7,2	11,7
Width		32	41,5	52	63,5	82,5

BESTMA[®] Convertible Type Torque Wrench TX

Technical Details BESTMA Hexagon Link

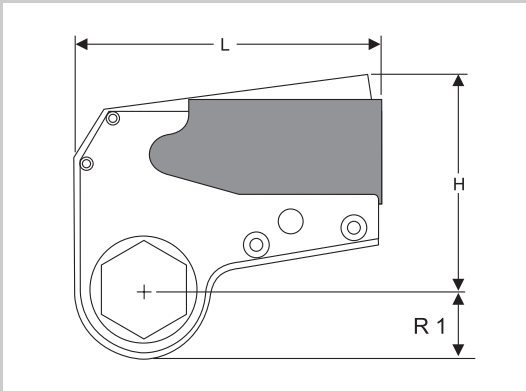

Standard Program: BESTMA - Hexagon Link for TX series

compatible with drive element

Ordering example: TX2-SK-SW 36

All dimensions are in mm

	TX2 -SK	SW 27	SW 30	SW 32	SW 36	SW 41	SW 46	SW 50	SW 55							
TX2	Thread	M 18	M 20	M 22	M 24	M 27	M 30	M 33	M 36							
	Weight kg	1,5	1,6	1,6	1,5	1,5	1,5	1,7	1,6							
	R1 mm	26	28	28	31	33	36	39	42							
	H mm	109	109	109	109	109	109	109	109	120						
	L mm	163	163	163	163	163	163	163	163	166						
	TX4 -SK	SW 36	SW 41	SW 46	SW 50	SW 55	SW 60	SW 65	SW 70							
TX4	Thread	M 24	M 27	M 30	M 33	M 36	M 39	M 42	M 45							
	Weight kg	2,8	2,9	3,2	3,2	3,2	3,3	3,3	3,4							
	R1 mm	34	34	37	41	44	46	49	52							
	H mm	140	140	140	140	140	140	140	151							
	L mm	200	200	200	200	200	201	203	206							
	TX8 -SK	SW 55	SW 60	SW 65	SW 70	SW 75	SW 80	SW 85	SW 90	SW 95						
TX8	Thread	M 36	M 39	M 42	M 45	M 48	M 52	M 56	M 60	M 64						
	Weight kg	6,4	6,4	6,6	6,5	6,5	6,6	6,9	6,8	6,9						
	R1 mm	46	49	52	55	58	61	65	67	79						
	H mm	178	178	178	178	178	178	178	178	184	203					
	L mm	261	261	261	261	261	261	261	261	261	270					
	TX16 -SK	SW 80	SW 85	SW 90	SW 95	SW 100	SW 105	SW 110	SW 115							
TX16	Thread	M 52	M 56	M 60	M 64	M 68	M 72	M 76	M 80							
	Weight kg	12,4	12,4	12,4	12,4	12,6	13,2	13,4	13,8							
	R1 mm	63	69	69	75	75	78	87	87							
	H mm	193	193	193	193	193	205	205	205							
	L mm	326	326	326	326	326	326	326	326	326						
	TX32 -SK	SW 80	SW 85	SW 90	SW 95	SW 100	SW 105	SW 110	SW 115	SW 120	SW 125	SW 130	SW 135	SW 140	SW 145	
TX32	Thread	M 52	M 56	M 60	M 64	M 68	M 72	M 76	M 80			M 96			M 100	
	Weight kg	27,0	28,1	27,7	27,9	27,7	29,5	30,8	31,8	32,2	32,2	31,5	29,9	34,7	35,3	
	R1 mm	71	76	76	82	82	88	94	94	100	100	100	104	109	109	
	H mm	228	228	228	228	228	228	228	228	247	247	247	247	247	247	
	L mm	401	401	401	401	401	401	401	401	401	401	401	422	422	422	



Torque wrench TU with handle, optionally

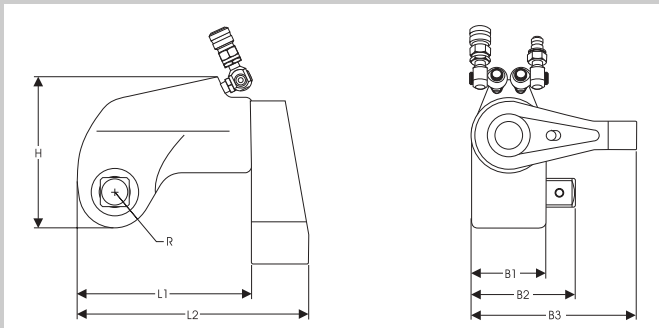
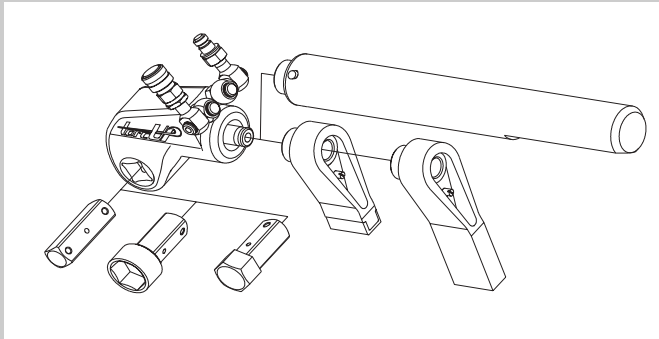

BESTMA-Torque Wrenches TU, are conceptionally and constructively advanced torque wrenches that provide torques up to approx. 78.000 Nm. The highly developed technology is proven to be effective and meets the high demands for easy handling, on the job safety and solidity.

Technical Information

- Exact torque
- Precise torque setting
- High operational safety
- Full body
- Long-term consistent torque accuracy through 2-hydraulic hose system
- Versatile accessories guarantee a wide range of application
- Easy plug in, or modification of the square drive from loosening to tightening of screw connections
- Ergonomic construction of thread
- Optionally you will find directly usable hexagon link attachments (STABI) and the complete range of power nuts (STACO) in our accessory program

BESTMA Torque Wrench TU

Type / Ref.No.	TU-2	TU-3	TU-7	TU-11	TU-27	TU-60
Square Drive	3/4"	1"	1 1/2"	1 1/2"	2 1/2"	2 1/2"
Min. Torque (Nm)	173	450	1000	1500	3700	7900
Max. Torque (Nm)	1730	4530	10060	14980	37000	78900
Weight (kg)*	1,7	4	8	13	31	58
Height H	107	135	177,5	198	259	292
Length L1	119	155	203	234	312	390
Length L2	158	206	273	310	414	518
Radius R	25	33	43	49,5	61,5	74
Width B1	51	67	91,5	100	133,5	167
Width B2	71	93,5	128,5	138	196	226
Width B3	112	147,5	202,5	221,5	295,5	363

* With support and square drive - Accuracy of +/- 3%

Specifications are subject to change